



 **blackbox-av**  
audio ■ video ■ interactive



## Single Cup Headphone Manual

## Safety Guide

*Read this guide carefully before using or installing the product.*

### Preventing accidents and protecting the health of the user of the Headphones

- Ensure the audio levels are set so ear damage cannot occur when someone is using the product.
- When tethering the armoured cable ensure there is no trip hazard created when the headphones are stored on its hanger.
- Over time, monitor the product to ensure there is no damage caused by deliberate vandalism which could harm other users.

### Preventing damage to the product and malfunctions

- As the product is not water-resistant install in a dry place where excessive liquid ingress may not occur.
- Clean the product regularly with a soft dry cloth or anti bacterial wipe.
- Ensure there is no pressure on the 3.5mm headphone jack when installed.
- Only use this product with good quality equipment with a dedicated headphone connection. Damage caused by defective audio equipment will void the warranty.

## Warranty

Blackbox-av provides a 12 month warranty with this product. For further information or advice please contact **info@blackboxav.co.uk**

# Your new Single Cup Headphones

## In the Box:

1. Single Cup Headphone
2. Magnetic Hanger
3. Knuckle Mounting Plate (optional)
4. Tear Drop Mounting Plate (optional)
5. Multi-Purpose Screws
6. Manual

## Single Cup Headphone

The Single Cup Headphone is both reliable and vandal resistant, suitable for any application within the public domain.

## AutoPlay Functionality

The AutoPlay version incorporates an Auto-Trigger function, this activates your audio playback device when the headphone is removed from its hanger.

## Mounting Plate (optional)

The optional mounting plates allows you to further strengthen the cable fitting point.

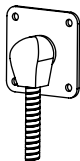
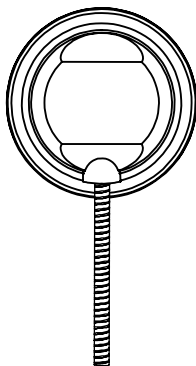

## Setting Up

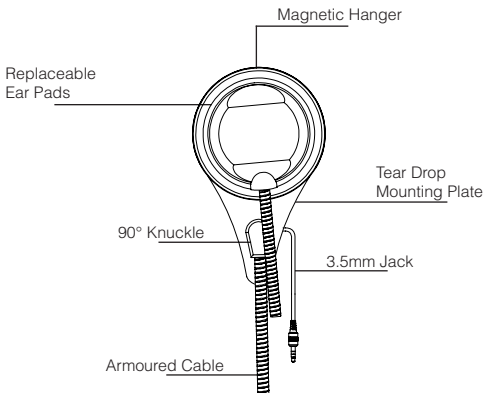

## Overview

### Modern Hanger

Offering an elegant and simple-to-use storage solution. The hanger has an optimised magnetic pull force, making it easier to remove with minimum effort, and equally straightforward to replace.

### Armoured Cable

The audio cable is protected by a 1.35m long stainless steel armoured conduit with a heavy duty strain relief.

### Fantastic Sound Quality

The internal speaker elements provide great dynamic range, reproducing audio with high clarity.

### 90° Swivel Knuckle

The supplied swivel knuckle is used to fix the cable in place, offering a secure anchor point and preventing cable fracture.

### 3.5mm Jack

Simply connect to your audio playback device via the 3.5mm jack.

### Replacement Parts

The design of the Single Cup Headphone is so robust it's likely to last for many years. However, over this time there tends to be wear on the perishable parts so to keep the headphone looking great we offer replacements, available to purchase on our online store.

## Identifying AutoPlay vs Standard

You will be able to identify whether your headphone has AutoPlay functionality through the existence of a **dimple** shown in the diagram below. It's located at the bottom of the headphone next to the audio cable.

With Dimple - AutoPlay

---

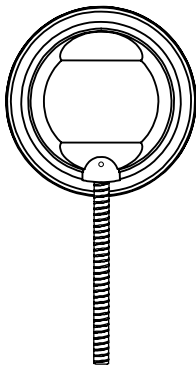

Without Dimple - Standard

---

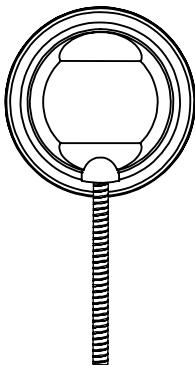

## AutoPlay Version

### AutoPlay Functionality

When used with a compatible device, the AutoPlay version allows the triggering of playback upon pickup. When the headphone is lifted, a sensor will trigger your content. When returned to the hanger, the content will stop.

### AutoPlay Cabling/SoundClip Range

AutoPlay functionality is supported by our SoundClip range of audio players. The headphone is supplied with a trigger and splitter cable, the 3.5mm jack is installed to the output, while the activation cables are wired to an appropriate button terminal on the SoundClip device.

**Note: Ensure the SoundClip is set to the correct mode. Refer to the SoundClip Range Manual for more information.**

### AutoPlay With Other Devices

You will need to check with the manufacturer of other playback devices to ensure compatibility. To connect to third party devices you will need to be aware of the cable connections as displayed below.

When the handset is removed from the hanger, the trigger is 'open'.

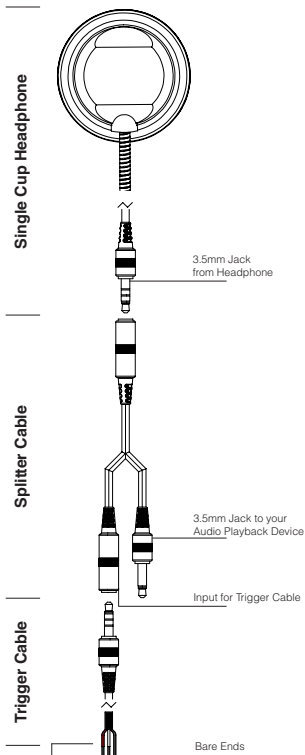
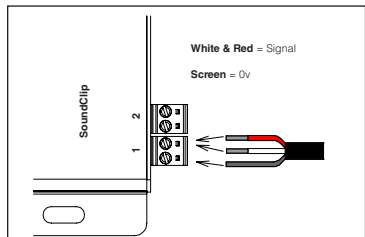

## Installation

### The Hanger

The Hanger needs to be mounted flush to a flat surface to allow the headphone to sit securely.

### The Knuckle & Mounting Plate

The knuckle should be mounted to a structure with a suitable hole for the knuckle nut to fit through (see technical drawings). Alternatively, you can fit the knuckle without the plate into a metal panel.

### Knuckle Hole

A cutout for the knuckle will need to be made to the correct measurements.

See technical drawings for the measurements.

### Optional Teardrop

The Teardrop mounting plate combines both the knuckle and Magnetic Hanger into a compact unit.

See technical drawings for the measurements.

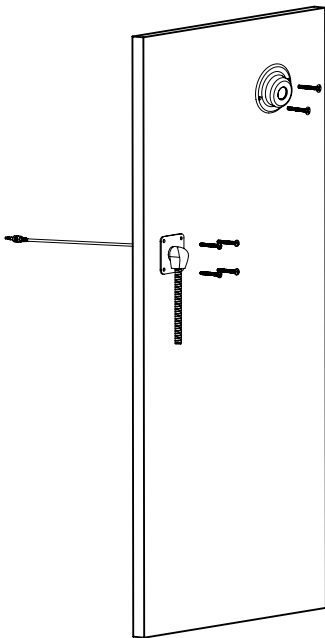

## Technical Information

<b>Unit Weight</b>	0.34Kg
<b>Packaged Weight</b>	0.5Kg (approx)
<b>Package Dimensions</b>	285W x 145D x 195H mm
<b>Unit Dimensions</b>	102.2W x 51.5D x 102.2H mm
<b>Nominal Impedance</b>	100Ω
<b>Frequency Range</b>	16 - 21.000 Hz
<b>Sound Pressure Level</b>	96dB (1mW / 1kHz)
<b>Input Power (W)</b>	Rated: 30Mw - Max: 50mW (?)
<b>Input Power (V)</b>	Rated: 1.7V - Max: 2.25V (?)
<b>Armoured Cable Length</b>	1350mm
<b>Trigger Cable Length</b>	300mm
<b>3.5mm Cable Length (from Knuckle)</b>	650mm (+/- 10mm)
<b>Screw Sizes</b>	Wood Screws (Driver bit No.2, 25mm)
<b>Switching Signal (AutoPlay)</b>	Handset on base: Contact closed/ handset off: Contact open
<b>Switching Capacity (AutoPlay)</b>	100 Vdc
<b>Switching Current (AutoPlay)</b>	approx. 22 dBa
<b>Operating Temperature</b>	-25°C to 60°C



# Technical Drawings

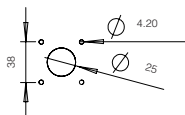
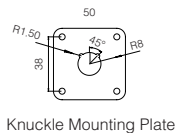
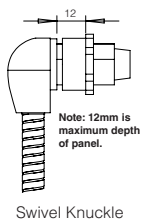
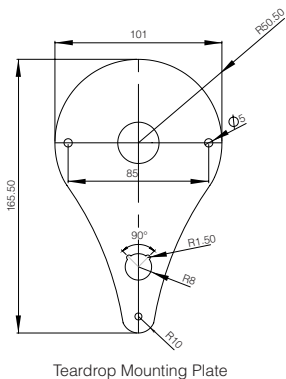
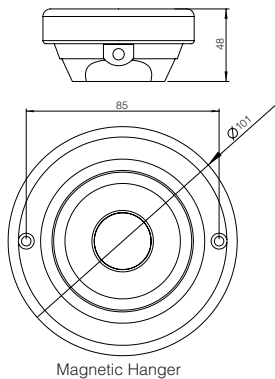
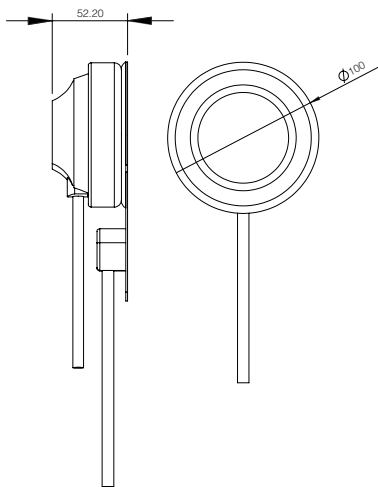

# Notes

# Notes

